

Inventor Drawing

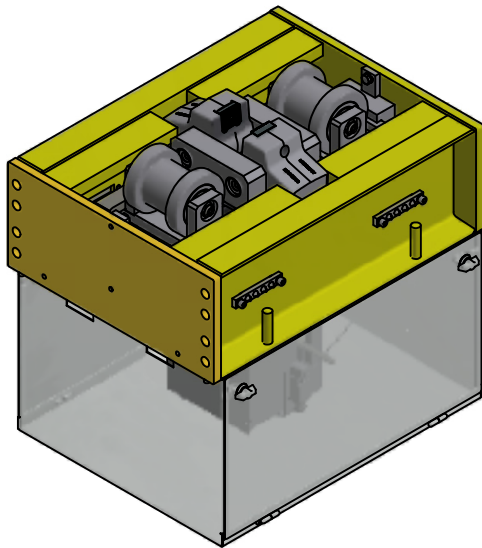

FEATURE	CODE
Rail Clamp Upside Down	CTHV-TSUD
Holding force	060
Coefficient of friction	050
Remote power unit	RP

Example for ordering	CTHV-TSUD-060-050RP
-----------------------------	----------------------------

TECHNICAL DATA

Nominal holding force (kN)	60
Standard release pressure (MPa)	7,3
Maximum operating pressure (Mpa)	8,75
Cylinder volume (full stroke) (cm3)	158
Cylinder volume (working stroke) (cm3)	140
Mounting holes	8 x Ø22
Mounting bolts	8 x M20 CL 8.8
Approximate weight (kg)	220
Mechanism - horizontal float (mm)	±25
Mechanism - vertical float (mm)	±25
Hydraulic connection	-6 37° JIC
Shipping crate (L x W x H) (mm)	1100 x 900 x 950

NOMINAL SPECIFICATION

Spring set - Hydraulically released device.

Control voltage electrical junction box connection to be drilled to suit requirements by customer.

RAIL WIDTH (mm)	MINIMUM TROUGH WIDTH TW (mm)
40 - 70	250
71 - 95	250
96 - 120	280

NOTES

All figures are nominal figures only.

All dimensions are in millimeters.

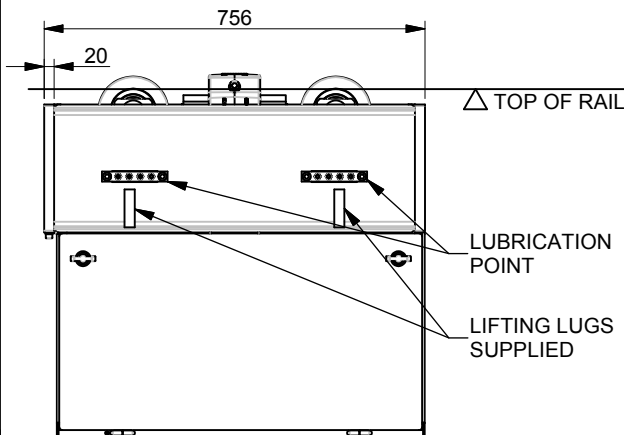
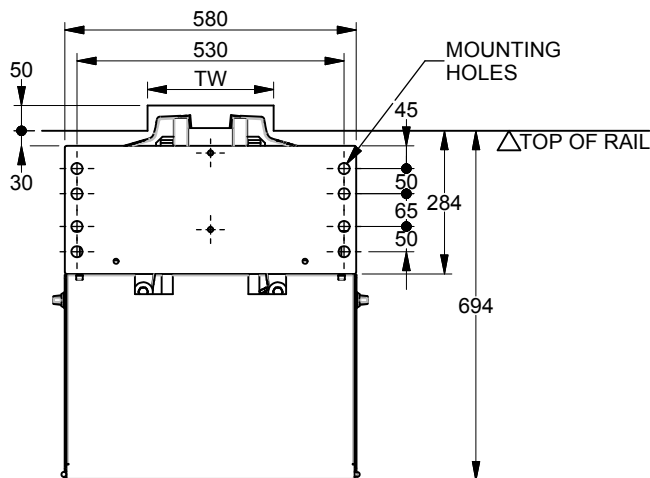

Document Template #710-101-62058

** ALL TECHNICAL DATA IS SUBJECT TO CHANGE WITHOUT NOTICE **

Hillmar works have a fully registered ISO 9001-2008 quality assurance programme (QCB #01-1525)

C:\TEMP\b10205ee-4241-46bc-e4bc-8ef6d48414fcb\80000524352\HILLMAR\HILLMAR PRODUCTION\02 STORM BRAKES\0700-2\07002014 CTHV-L HUD\SPC-SHT-CTHV-L HUD\78366 CTHV-TSUD-060-050RP.idw